

Installation Guide

TS1200 Pro Series Tripod Turnstile

Version: 1.2

1 Installation Requirements

1. It is recommended that the tripod turnstile must be installed on a horizontal solid platform with a height of 50mm to 100mm.
2. It is also recommended that the tripod turnstile should not be used in the corrosive environment.
3. Make sure that the ground wire of the system is securely connected to avoid personal injuries or other accidents.
4. After installation, check if the connection has been done correctly at the connecting points of the ground wire, at the connector assemblies and wiring points of the circuits, as well as at each movable part of the tripod turnstile. Any loose nuts, screws and other fasteners should be tightened in time to avoid any failures caused by long-time operations.

2 Installation Environment

The installation position of the tripod turnstile depends on its size. A distance of 100mm between the tripod turnstile and the wall needs to be reserved for ease of opening the top lid of the turnstile to perform maintenance and adjustment. The reference figure is shown below:

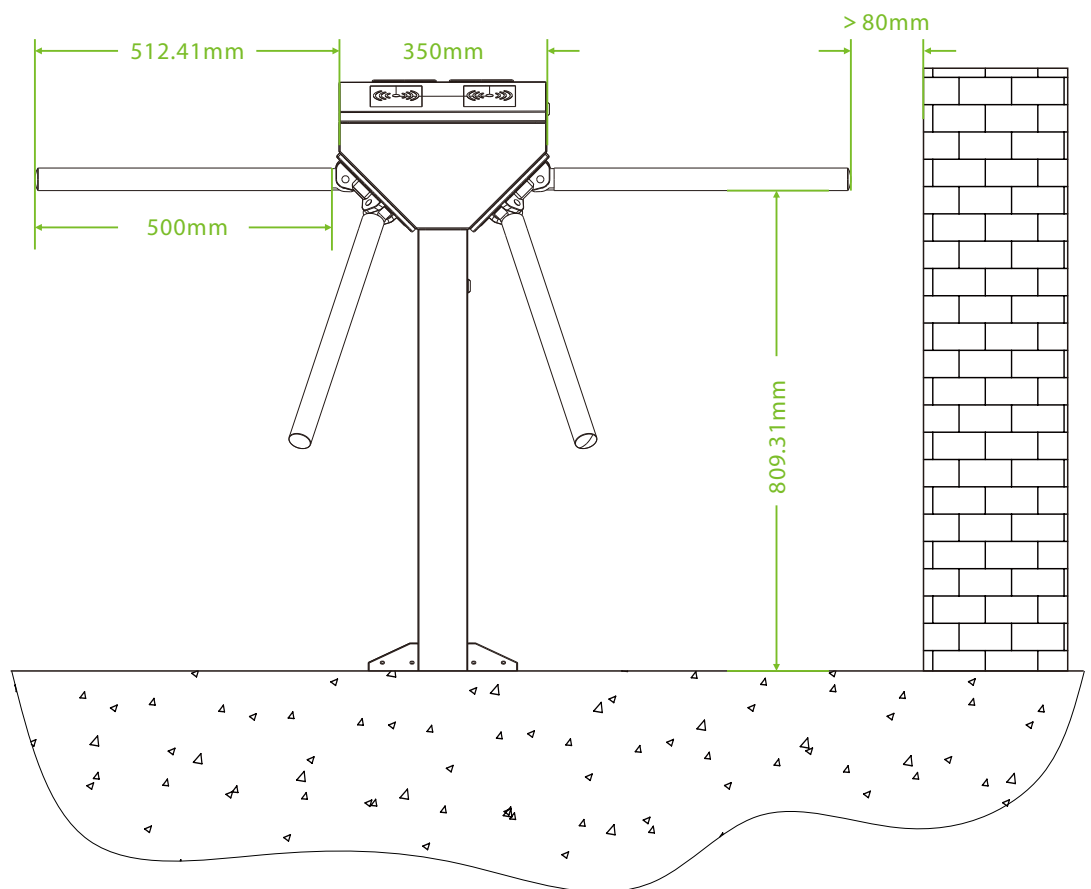

3 Preparation

The following items are required before installing the TS1200 Pro:

- **A Screwdriver:** To remove or install the screw on the device.
- **A Pencil:** To mark the device size and the screw hole.
- **A Electric Drill:** To drill holes in accordance to the marked screw holes.
- **A Wrench:** To secure the M12 expansion screw on the device.
- **A Tapeline:** To measure the dimensions that need to be measured during the installation of the device.
- **A Hex Wrench:** To remove or install the screw on the device.
- **Cutting Machine:** To cut the road and lay cables.

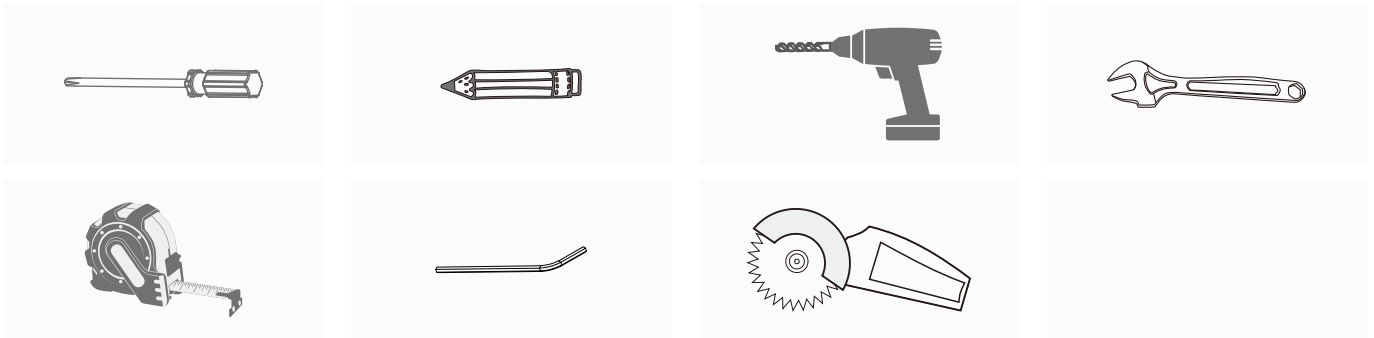

Note: Except for the hex wrench, all other tools should be prepared on your own.

4 Installation

1. Place the turnstile at the installation location.

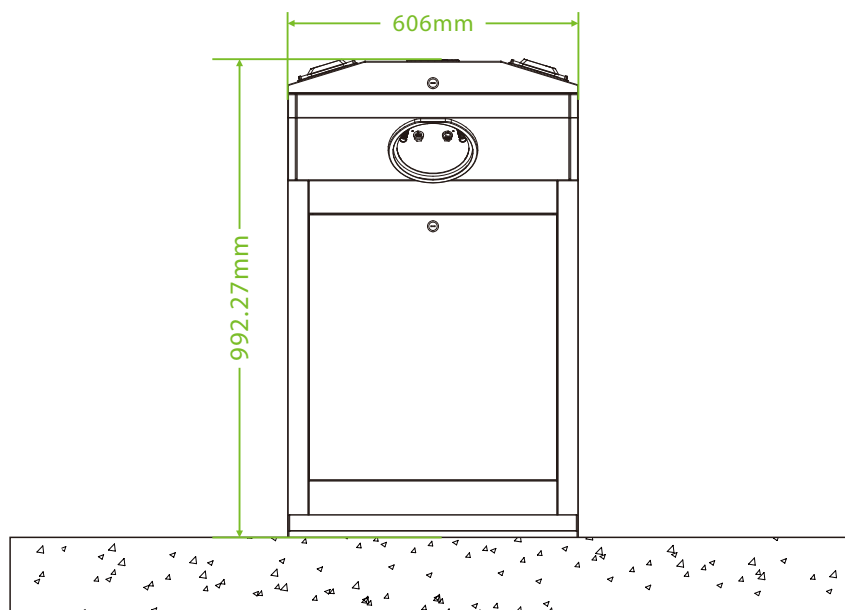

2. Open the chassis of the turnstile with the key and remove the chassis covers.

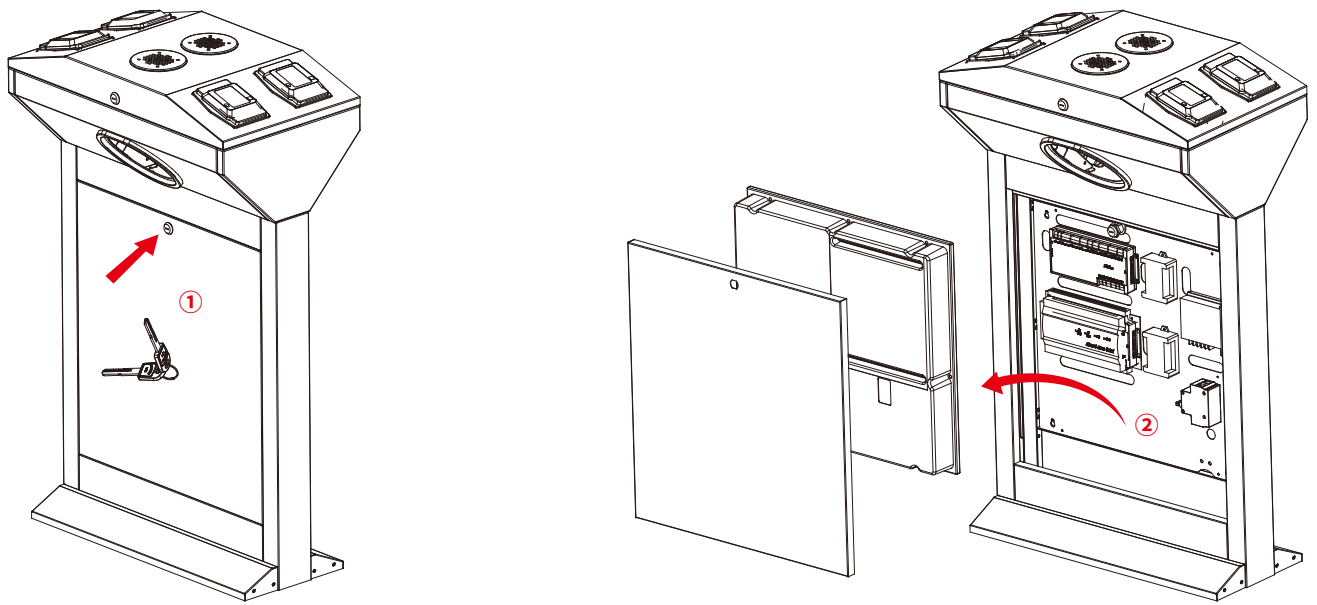

3. Remove the screws and the chassis covers.

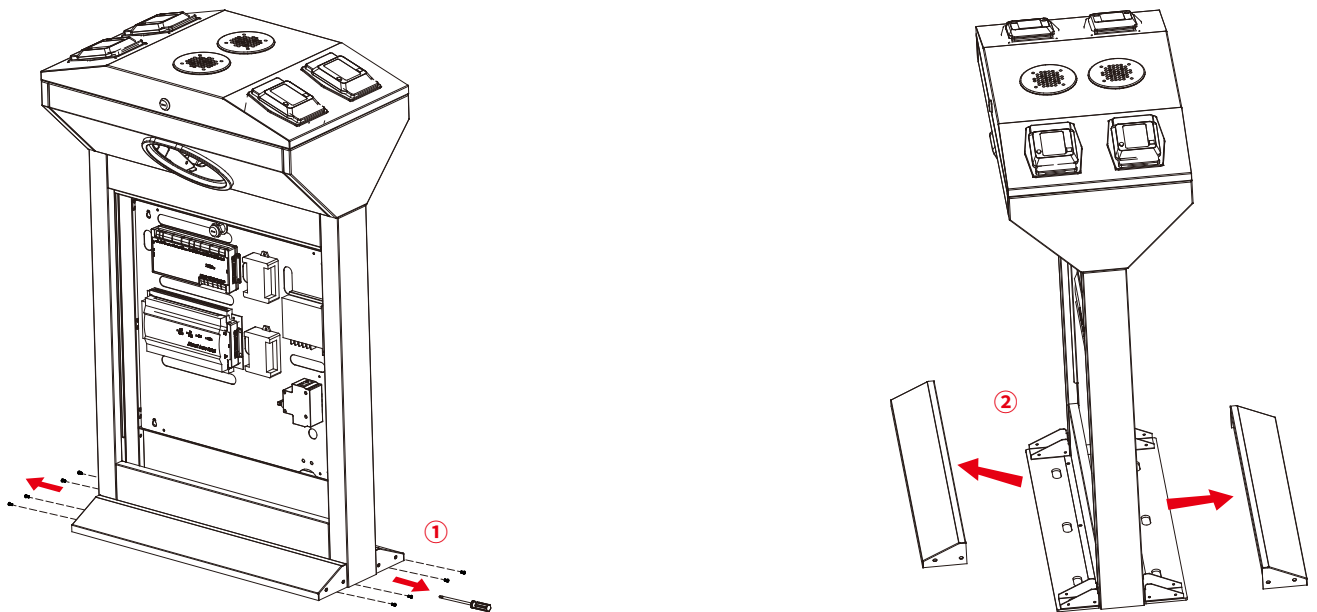

4. Use a pencil to mark the holes on the turnstile.

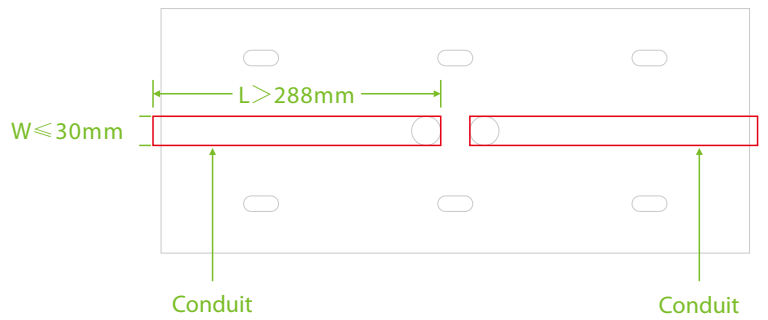
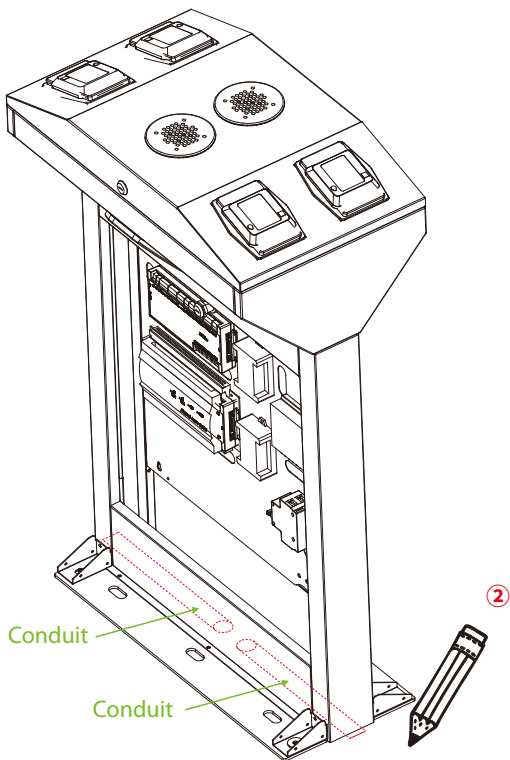
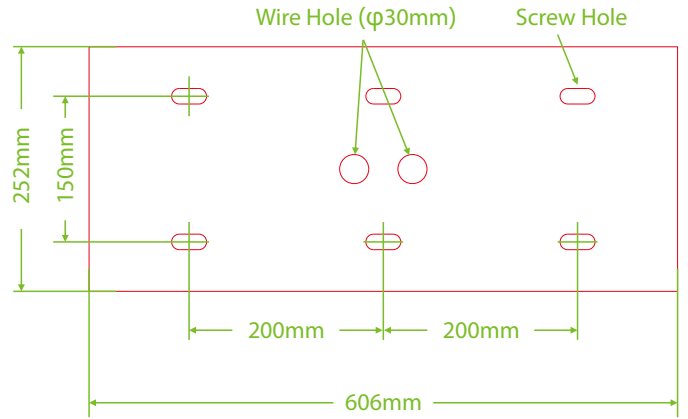
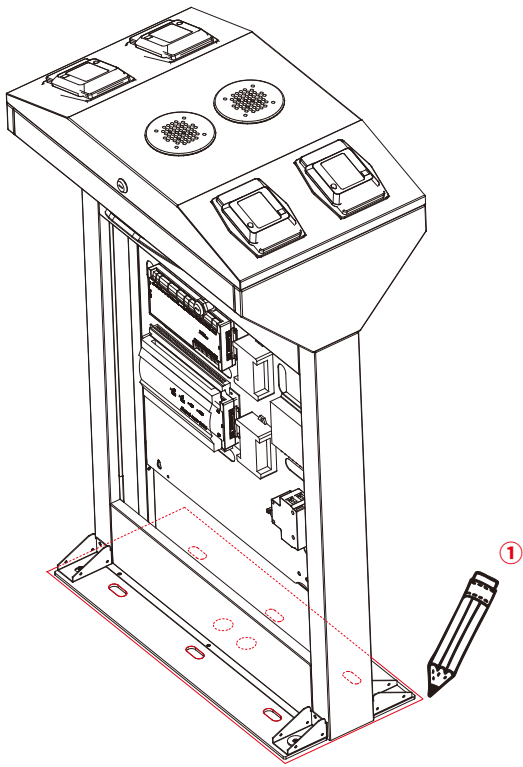

5. Remove the turnstile and use an electric drill to drill holes according to the markings.

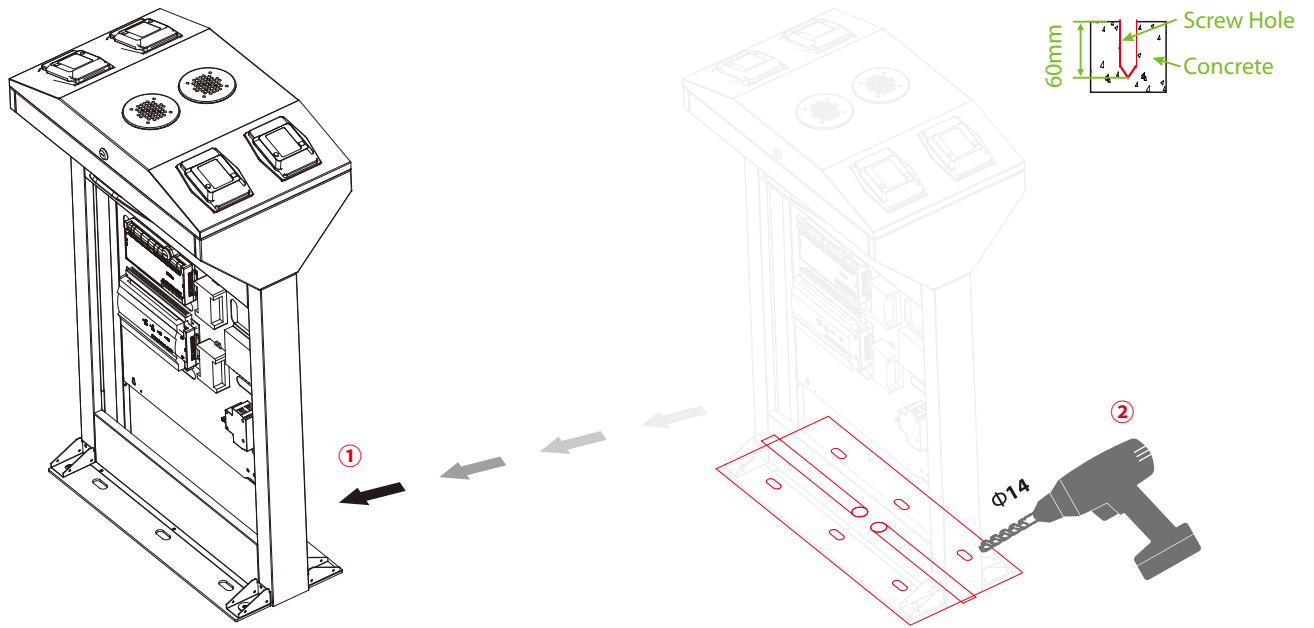

6. According to the wire hole, a cutting machine makes two conduit that is 30mm wide and 60mm deep.

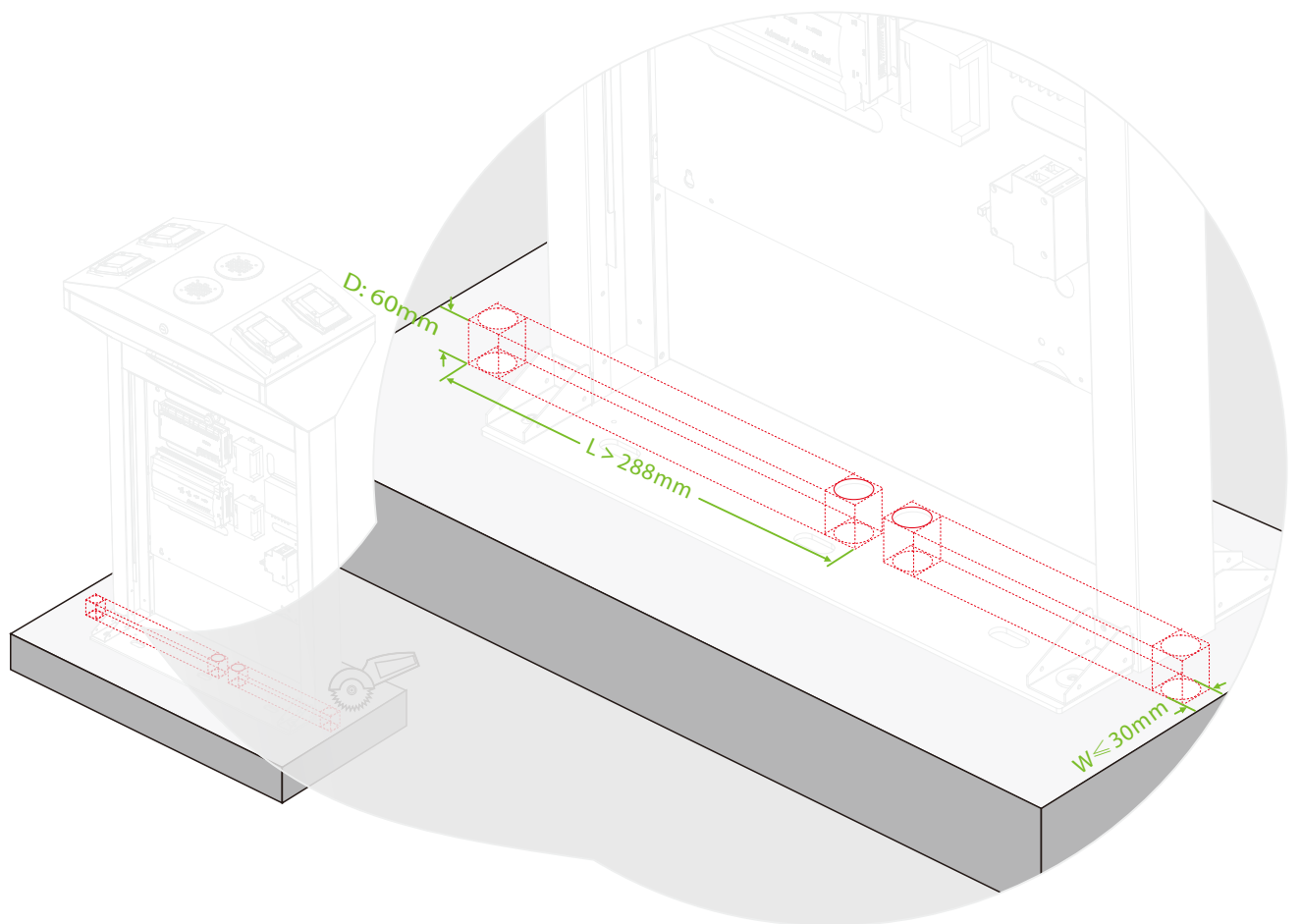

7. Clean up the debris and dust after drilling, and then place the turnstile on the installation site again. Check whether the drilled holes are align with the mark on the turnstile.

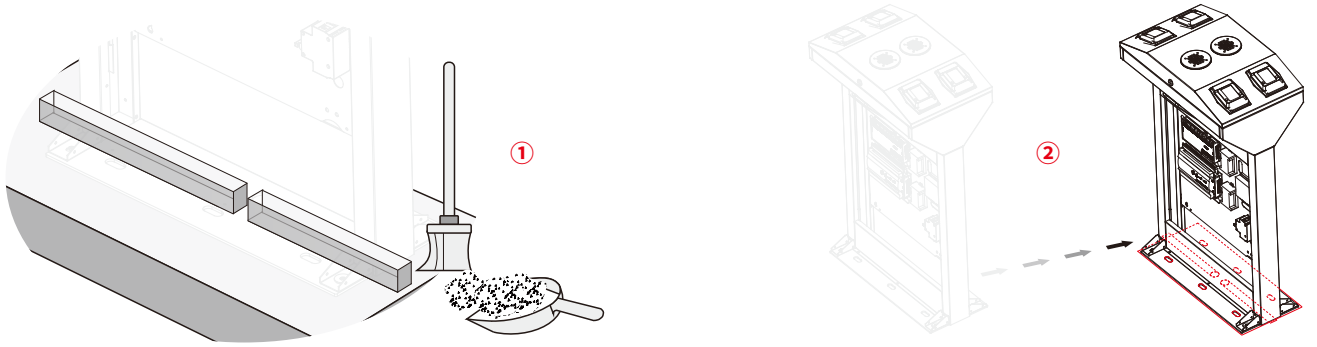

8. Put $\phi 20\text{mm}$ PVC pipe, and insert Ethernet and Power cables through the pipes lines, and then pour the concrete to fill the slot.

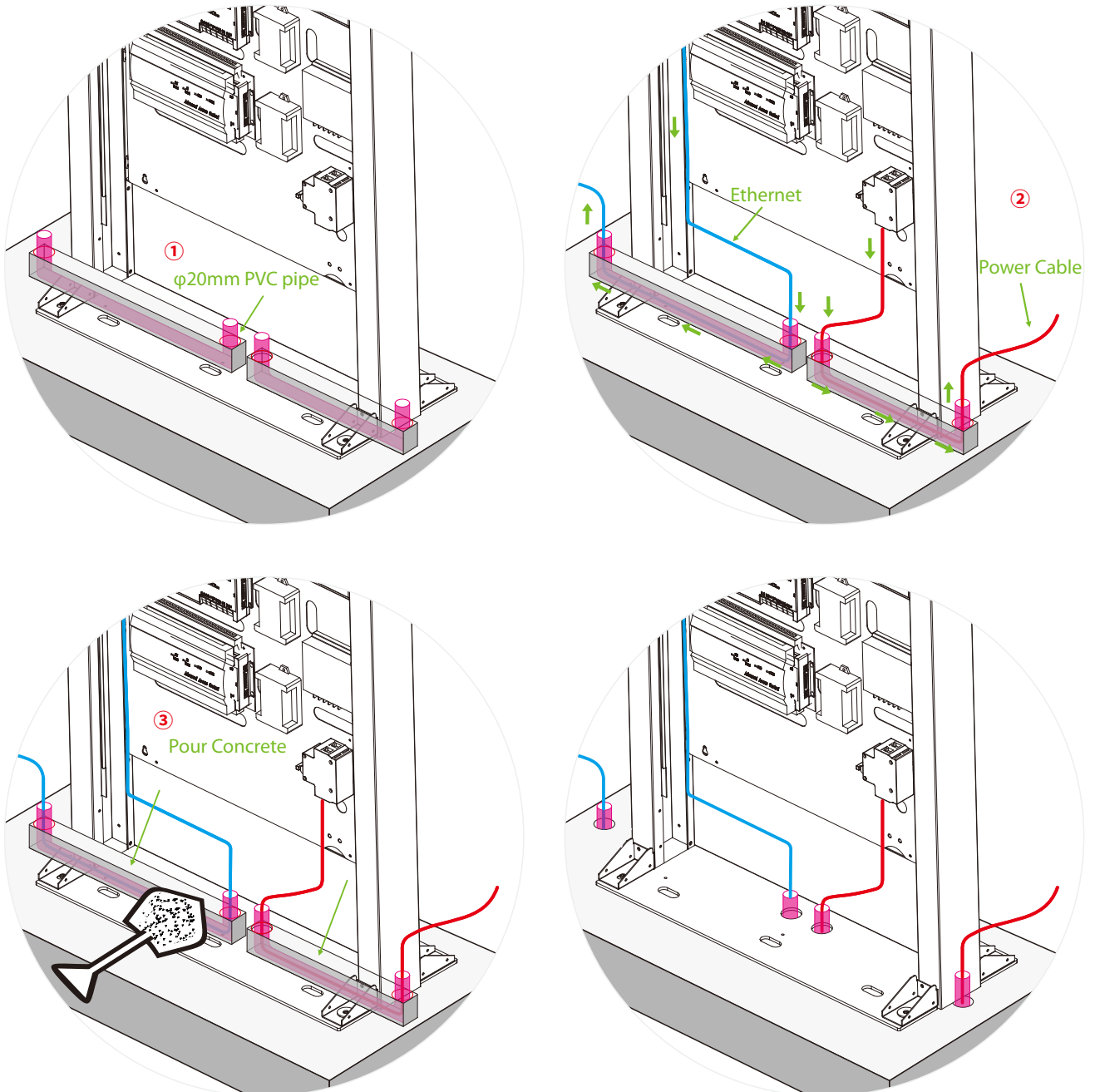

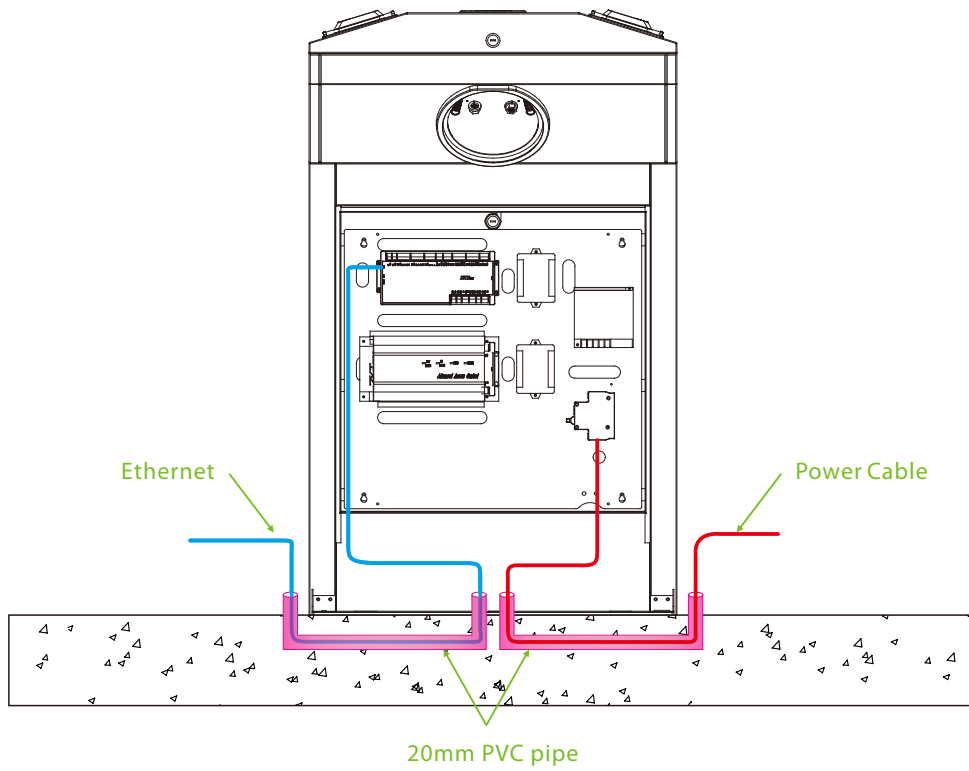

9. Align the device with the drilled holes. Then, insert the bolts accordingly and fix them with a wrench. Finally, insert the washers and the nuts, then tighten it with a wrench.

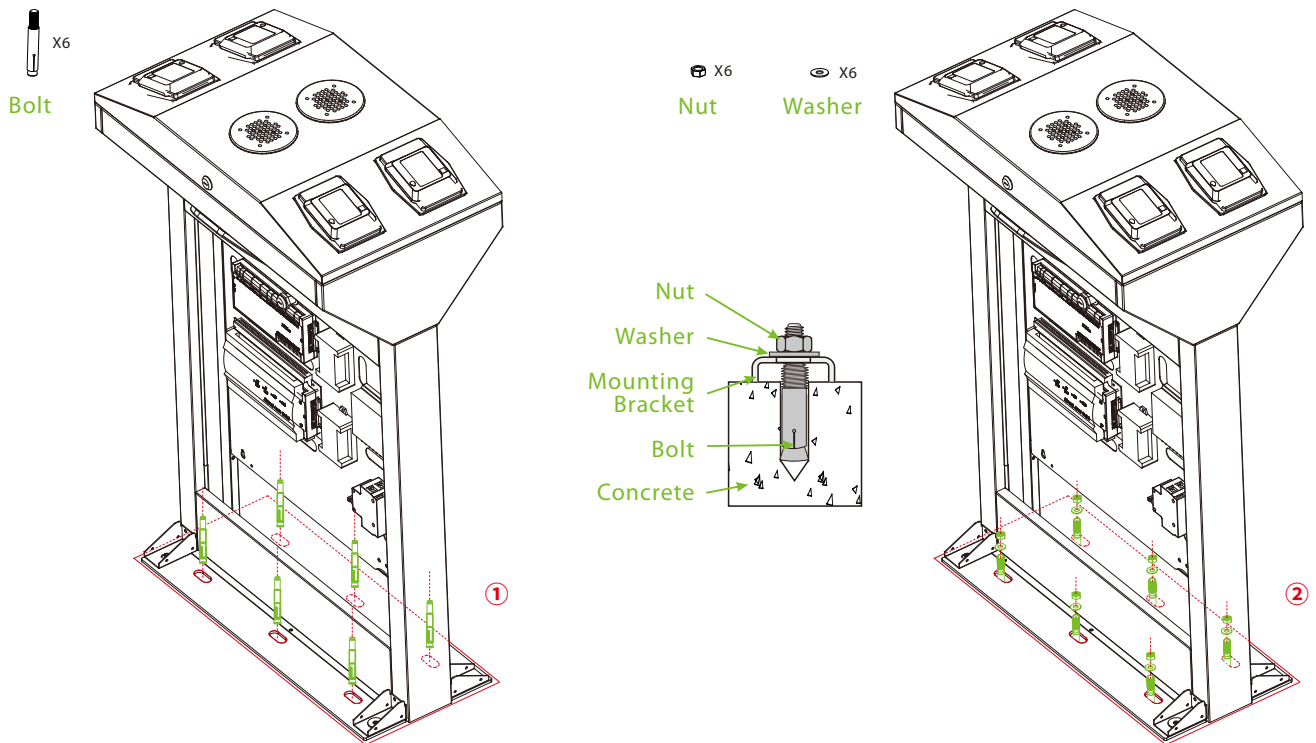

Note: Before inserting the bolt, the user must disconnect the Power and Ethernet cables from the machines and put them into the wire slot.

10. Install the chassis covers with the screws.

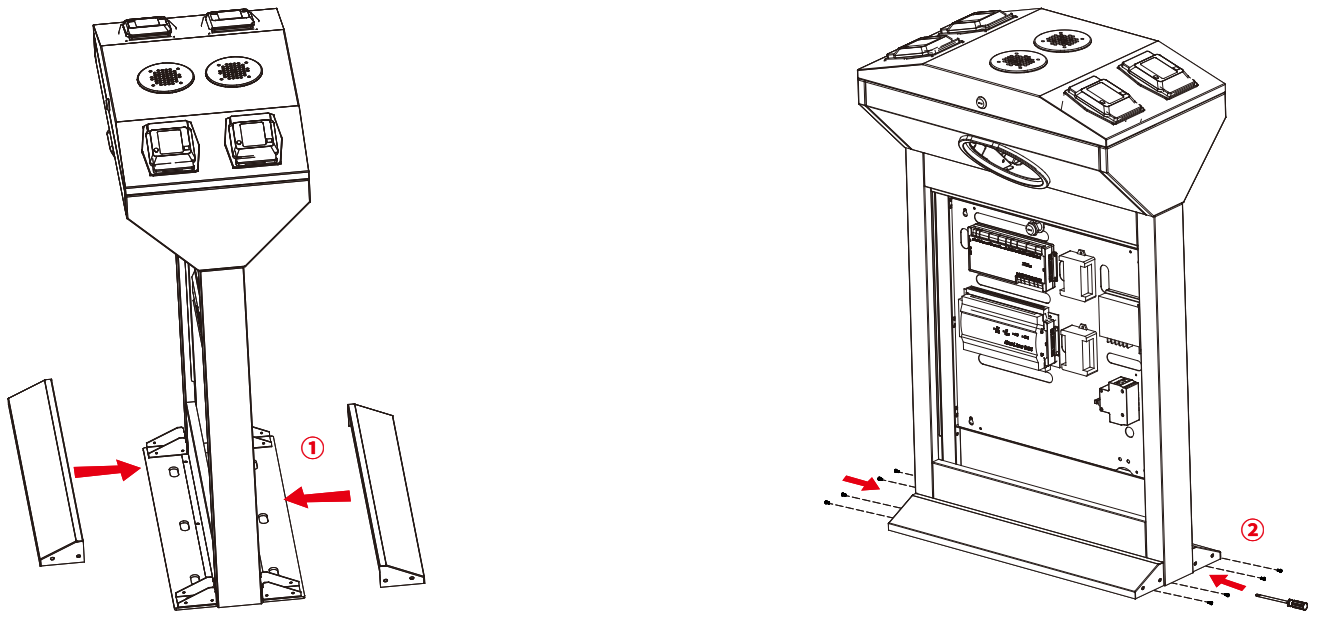

11. Install the chassis covers and use the key to lock it.

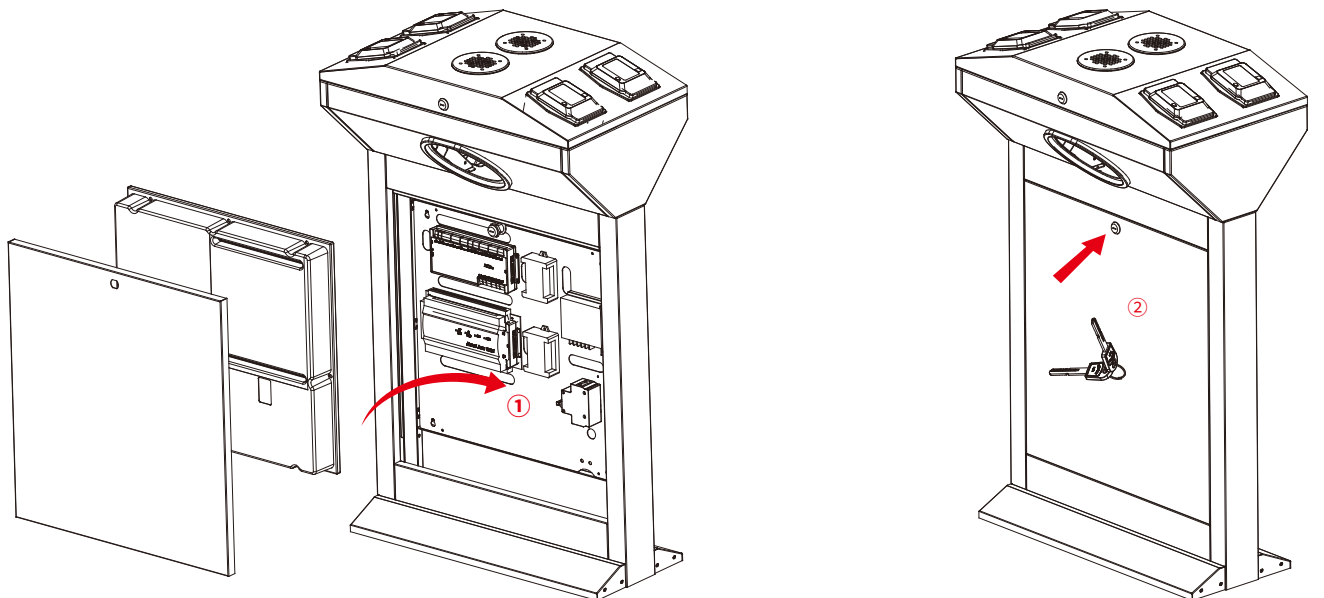

12. Use the key to open the top lid of the turnstile.

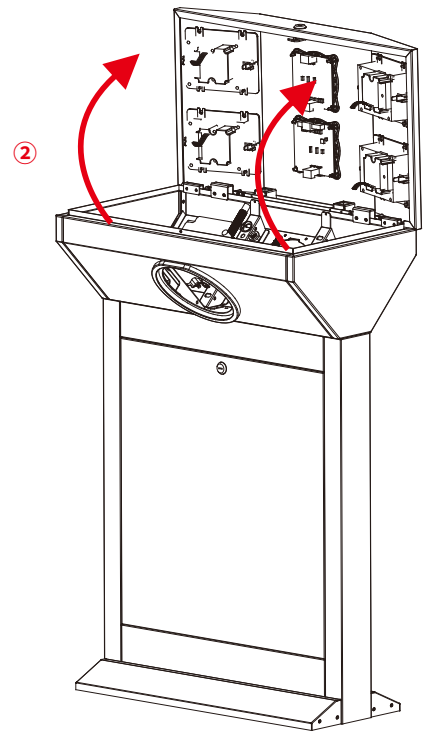
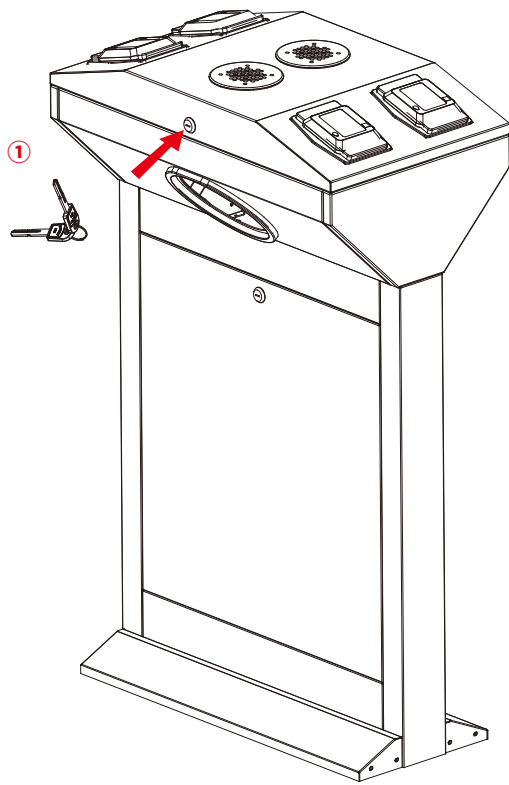

13. Align the arm assembly with the internal chassis assembly, and then secure it with the screws.



Allen Screw

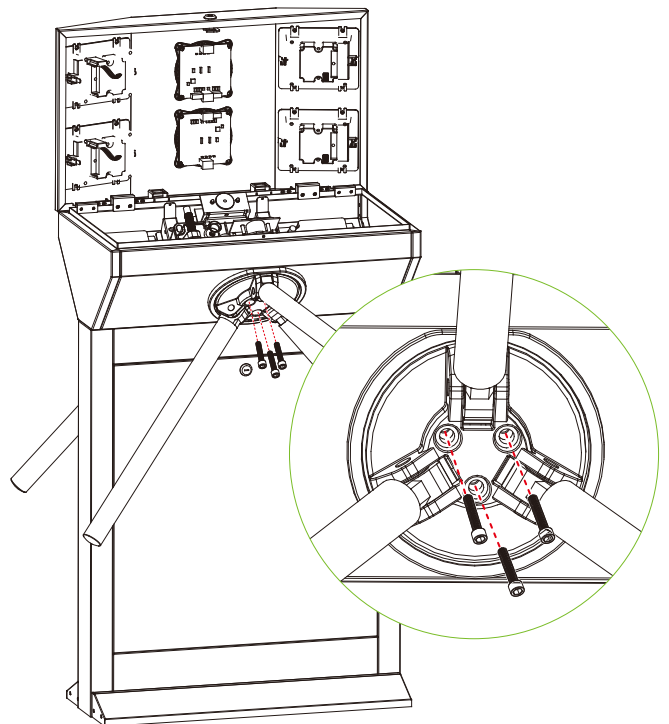
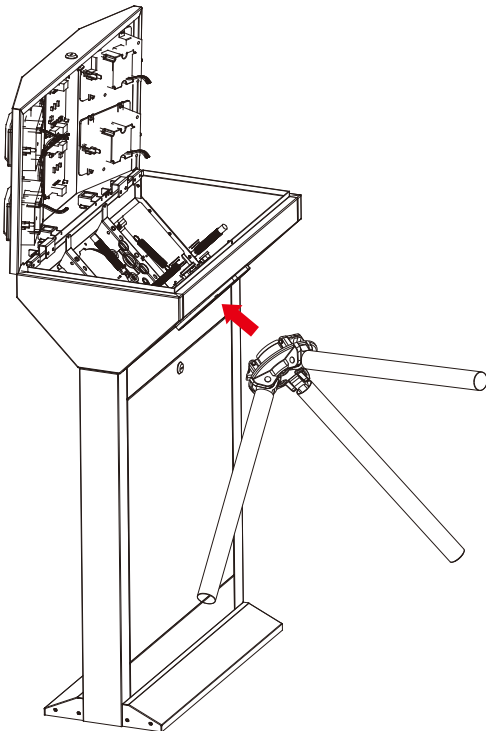

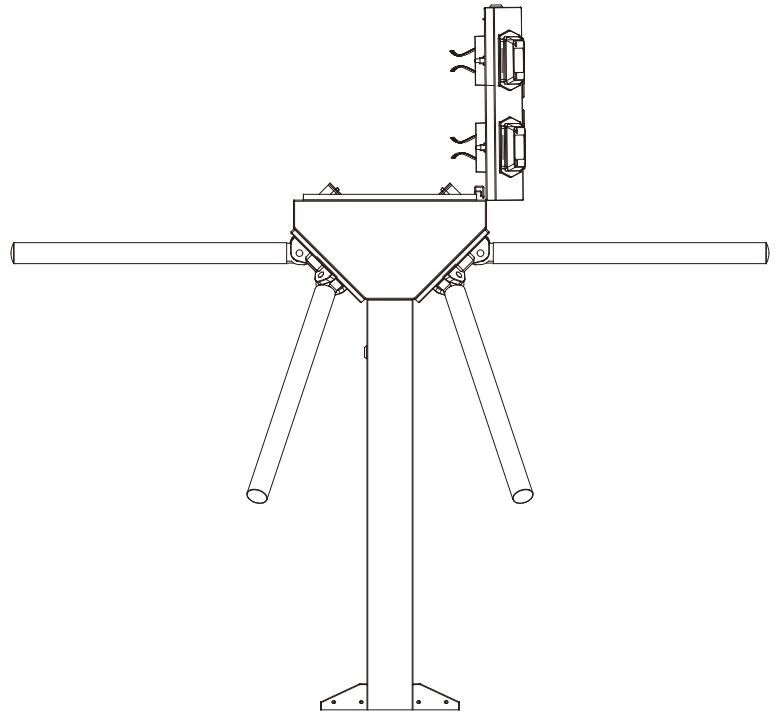
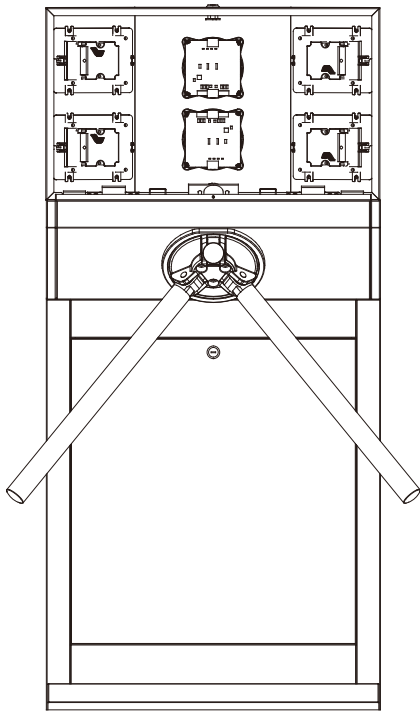

14. After assembling the arm, the resistance of the arm can be adjusted by rotating the damper left and right. Rotate the damper and observe the number on the damper. The resistance will increase as the number increases.

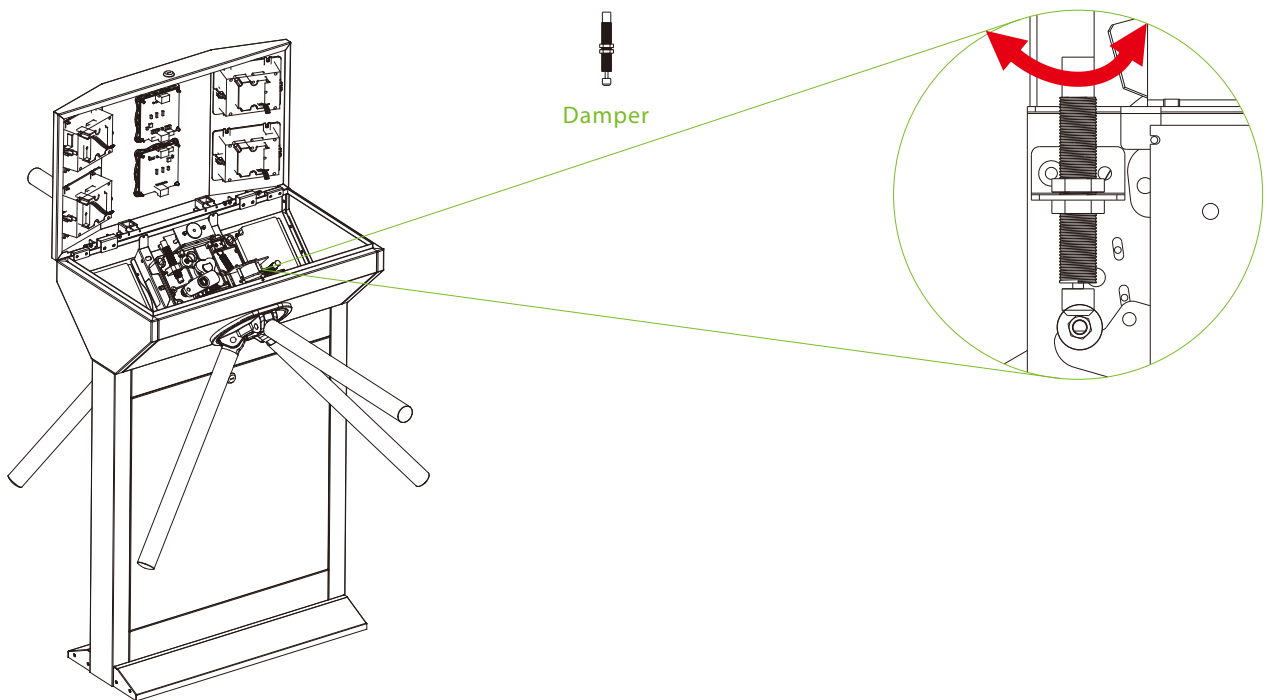

Note: When the turnstile is at a low temperature of -20°C , it fails to return properly to zero at the default damper setting, and the damper value needs to be adjusted downward.

15. Close the top lid and lock it.

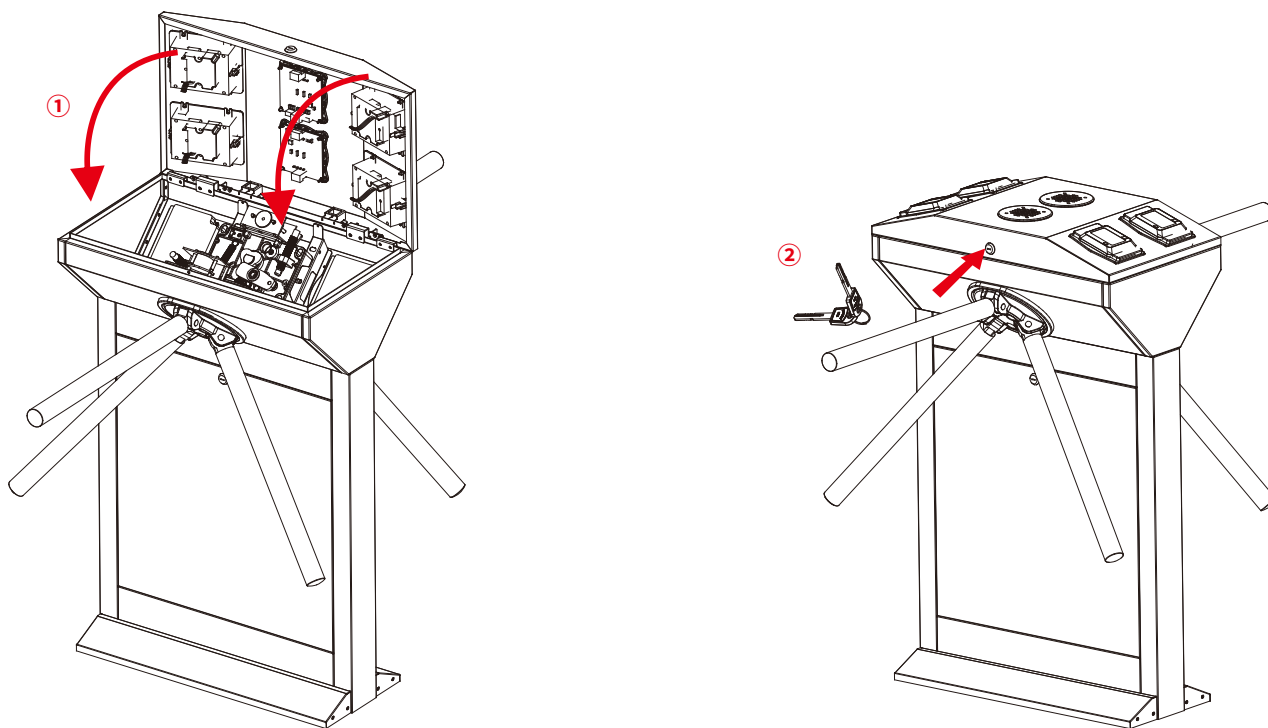

16. We suggest marking a warning line on the floor to remind the user, when installation is completed. It reminds the user to wait outside the warning line until the previous user completed the verification process and passed through the turnstile.

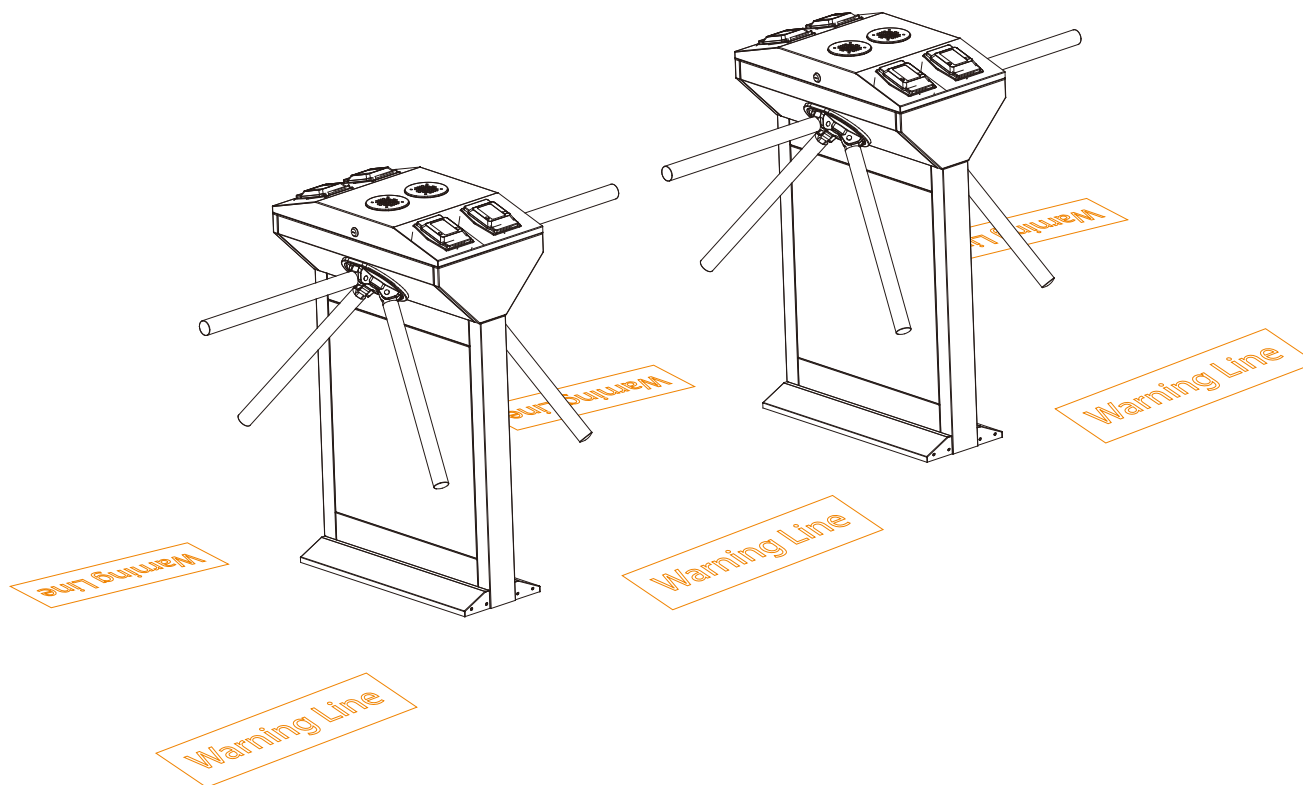

5 Wiring Diagram

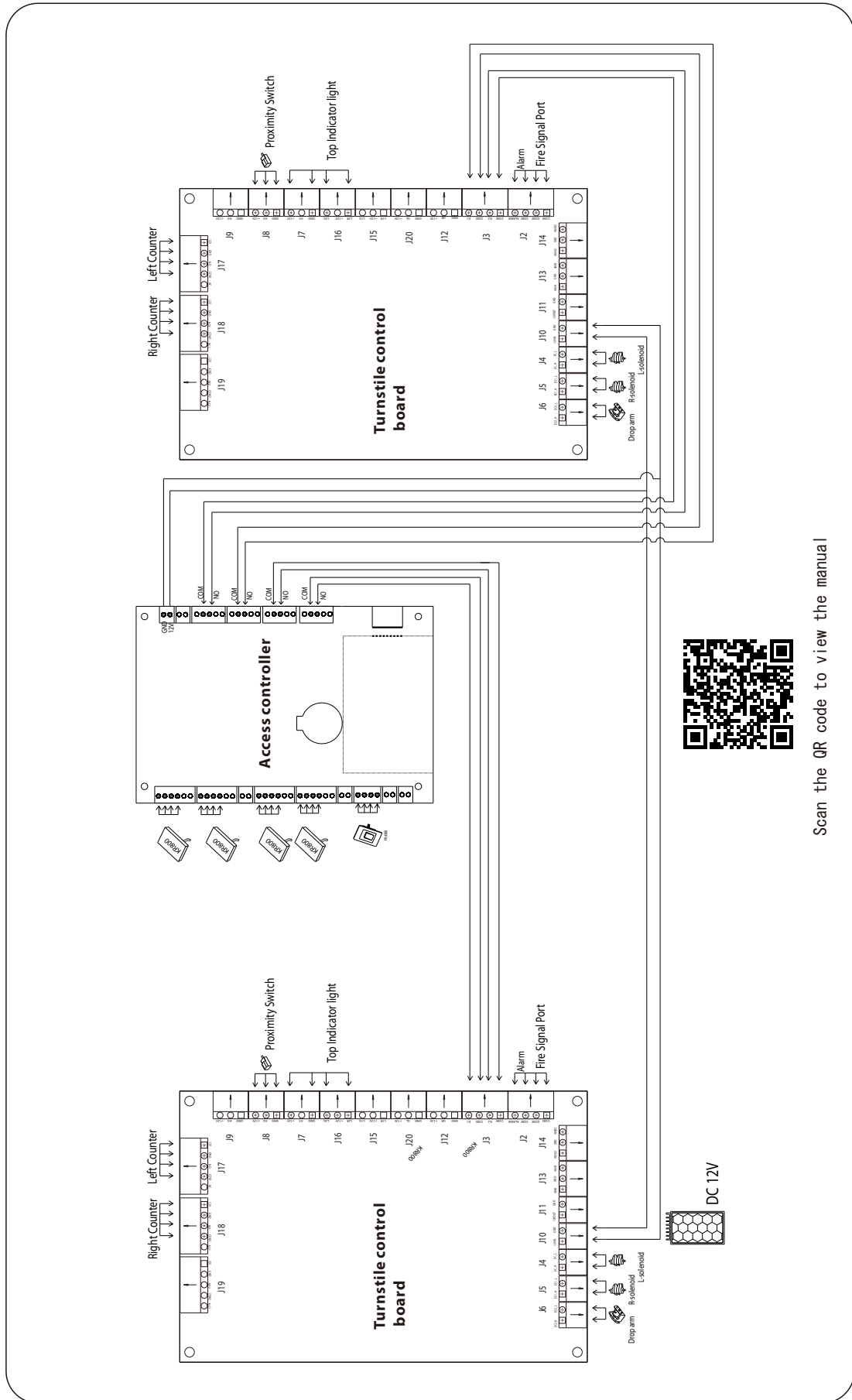

Scan the QR code to view the manual

ZKTeco Industrial Park, No. 32, Industrial Road,
Tangxia Town, Dongguan, China.

Phone : +86 769 - 82109991

Fax : +86 755 - 89602394

www.zkteco.com

